

**ONTEC S**

CBA, CBM				M1/C1/W1/F1 60/180				CB 24/48 CBM 48				
AC	L1 ON	L1 OFF	LON	LOFF	ON	60 NM	180 NM	ON	60 NM	180 NM	ON	M
NM												
M												

CBA, CBM (ONTEC S)											
INPUT			DIP-SW	CB	OUTPUT	INPUT			DIP-SW	CB	OUTPUT
L+	L1	L		COMMAND	LIGHT SOURCE	L+	L1	L		COMMAND	LIGHT SOURCE
1	DC ON	AC ON/OFF		-	ON	6	AC ON/OFF	AC OFF		-	ON
2	AC ON	AC ON/OFF		-	ON	7	AC ON	AC ON		-	ON
3	AC OFF	AC ON/OFF		-	OFF	8	AC OFF	AC ON		-	OFF
4	AC ON	AC ON/OFF		-	ON	9	AC ON/OFF	AC ON		EM	ON
										M	ON
										NM	OFF
5	AC ON/OFF	AC ON		-	ON	10	AC/DC OFF	AC ON/OFF		-	OFF

60/180 (AT, DT, D2, D2R, DA, D3, D3R, DL, TC, DB)				60/180 (ST)				(CB+, CBM, CBA)			
1h NM		X 0 A**** *60	X 0 A**** *60	NM		X 0 A**** *180	X 0 A**** *180	ON		ON	Z 0 ****E** *
3h NM		X 0 A**** *180	X 0 A**** *180								
3h M		X 1 A**** *180	X 1 A**** *180								

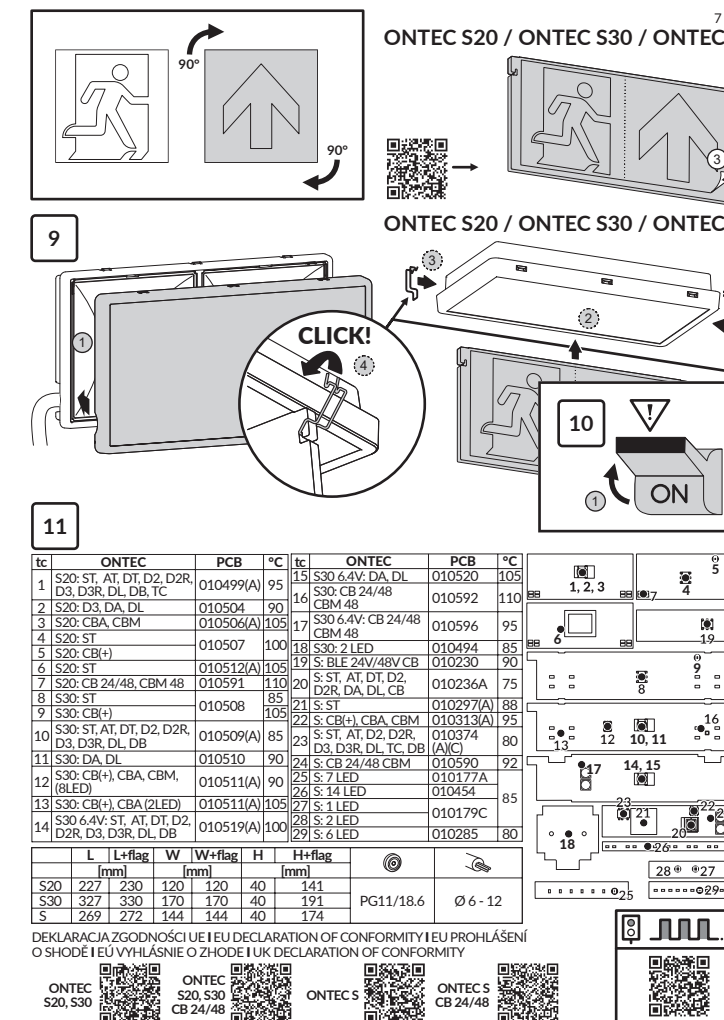
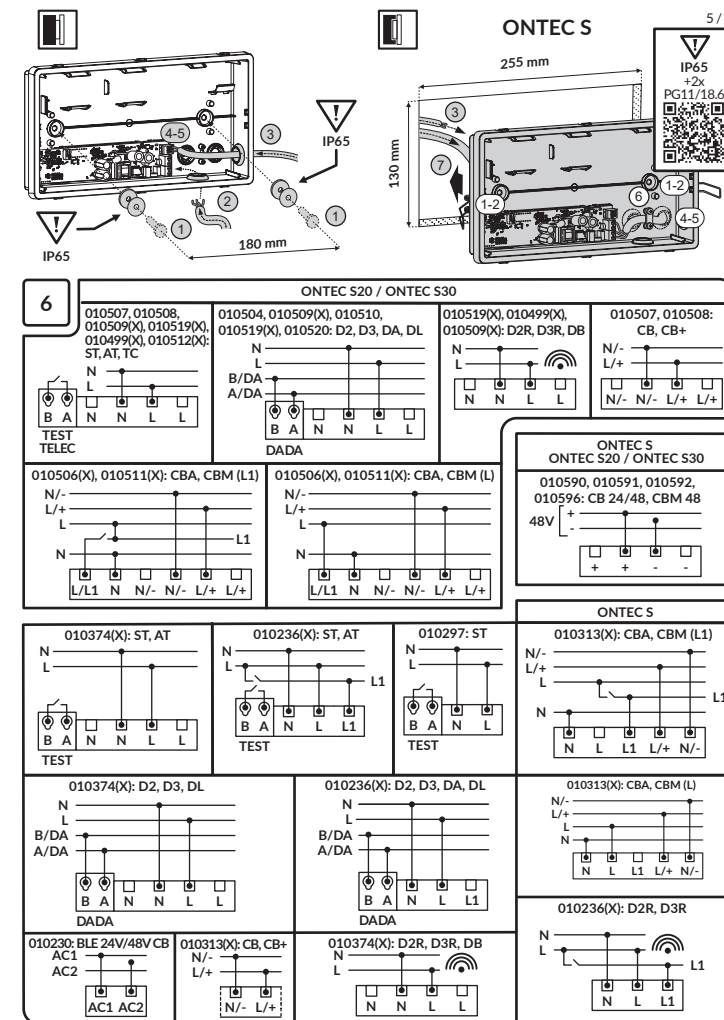

**2** ONTEC S20 / ONTEC S30  
ONTEC S

**3** ONTEC S20 / ONTEC S30

Mx/Cx/Wx/Fx 60/180				OS20 M2 180				CB 24/48, CBM 48			
ON		1 2 3 4		ON		1 2 3 4		ON		1 2 3 4	
NM		1 2 3 4		ON		1 2 3 4		ON		1 2 3 4	
M		1 2 3 4		ON		1 2 3 4		ON		1 2 3 4	

M1X (CBA, CBM)					
AC	L1 ON	L1 OFF	LON	LOFF	AC/DC
NM					High
M					Low

CBA, CBM (ONTEC S)											
INPUT			DIP-SW	CB	OUTPUT	INPUT			DIP-SW	CB	OUTPUT
L+	L1	L		COMMAND	LIGHT SOURCE	L+	L1	L		COMMAND	LIGHT SOURCE
1	DC ON	AC ON/OFF		-	ON	5	AC OFF	AC OFF		-	ON
2	AC ON	AC ON/OFF		-	ON	6	AC ON	AC ON/OFF		-	ON
3	AC OFF	AC ON/OFF		-	OFF	7	AC ON/OFF	AC ON		EM	ON
										M	ON
										NM	OFF
4	AC ON	AC ON/OFF		-	OFF	8	AC/DC OFF	AC ON/OFF		-	OFF

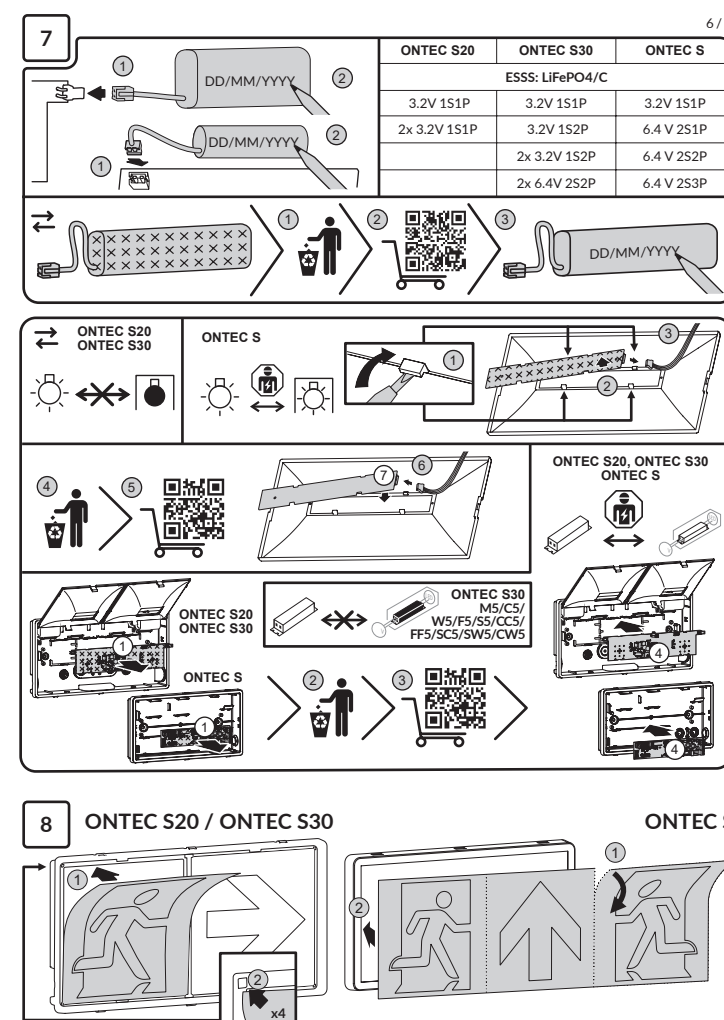
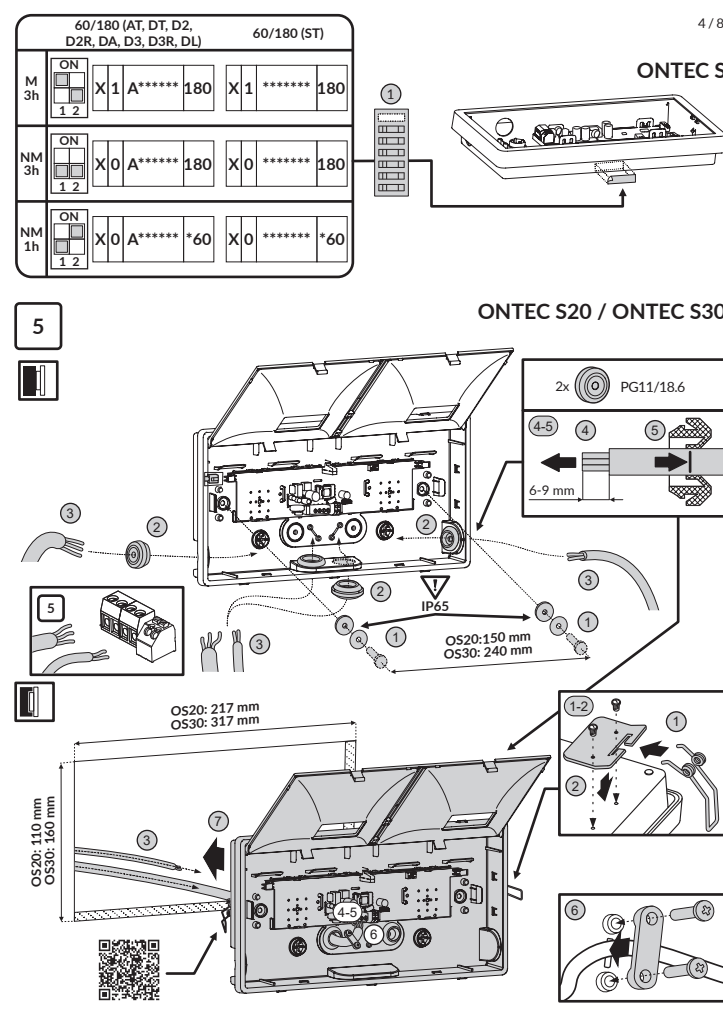

**TM TECHNOLOGIE**  
Manufacturer of emergency lighting

**TM.ONTEC S20**  
**TM.ONTEC S30**  
**TM.ONTEC S**

11.06.2026  
I.S.X.V3.1

TM TECHNOLOGIE Sp. z o.o.  
Morawica 355, 32-084 Morawica,  
gm. Liszki, Poland.  
tel.: +48 12 444 60 60  
fax: +48 12 350 57 34  
www.tmtechnologie.pl

S20: 0.5 m  
S30: 2.0 m  
S: 0.7 m

IP44  
IP65

LED

850°C

1h/3h

S20: 20 m  
S30: 30 m  
S: 25 m

210 ÷ 250 V AC, 50 / 60 Hz, 186 ÷ 254 V DC,  
CB 24/48, CBM 48: 20 ÷ 57 V DC;  
24V CB: 19 ÷ 27 V AC, 50 / 60 Hz, 20.5 ÷ 40 V DC  
48V CB: 38 ÷ 55 V AC, 50 / 60 Hz, 38 ÷ 72 V DC

ST, AT, DT, D2, D2R, D3, D3R, DA, DL, DB: +0 ÷ +40°C  
ST, AT, DT, D2, D2R, D3, D3R, DA, DL, DB (S IP44): +10 ÷ +40°C  
TC: +10 ÷ +40°C CB, CB+, CBM (S30 v5): -25 ÷ +35°C  
CB, CB+, CBM (S/S20): -15 ÷ +55°C CB 24/48, CBM 48 (S30 v5): -25 ÷ +35°C  
CB, CB+, CBM (S30): -25 ÷ +55°C CBA (S30 v5): -10 ÷ +35°C  
24V/48V CB: -15 ÷ +55°C COLD (S30 v5): -15 ÷ +35°C  
CB 24/48, CBM 48: -25 ÷ +55°C  
CBA: -10 ÷ +40°C 6M 0 ÷ +25°C  
COLD: -15 ÷ +40°C 3M 0 ÷ +35°C  
COLD CBA: -25 ÷ +20°C 1M 0 ÷ +45°C

65±20  
no condensing

\*CB 24/48, CBM 48, 24V/48V CB y=M/C/W/F/S/CC/FF/SC/SW/CW

